

# MODEL TS

## RUBBER FLOOR INSULATOR

For floating floors, it has a central channel so it can be secured, when desired, with a washer and screw.

It is the only isolator on the market with these features; it is highly effective thanks to its four supports, which facilitate considerably a secure positioning on the ground, improving its performance at low frequencies.



### APPLICATION EXAMPLE

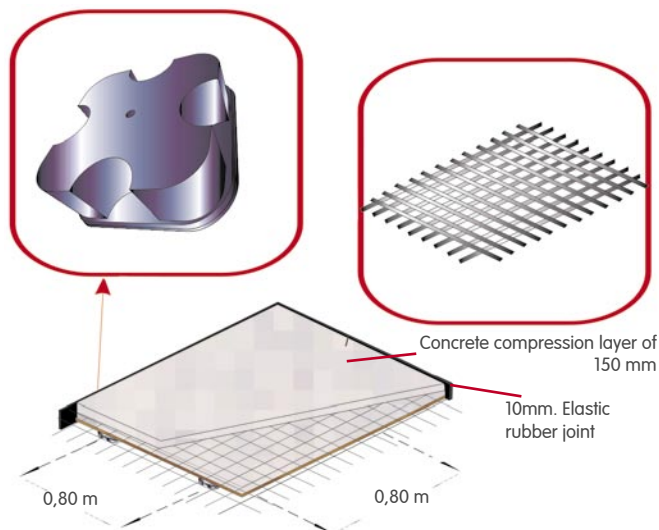

REF.	MODEL	PACKAGING	COLOR	MIN-MAX (Kg) LOAD
SE-TS-40 V 200	TS	50 U/B	■	80-200
SE-TS-80 A 400	TS	50 U/B	■	200-400

## DIMENSIONS

### Mod. TS

(Measurements expressed in millimetres)

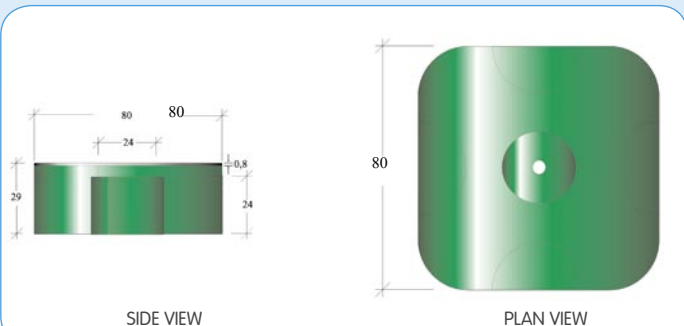

SIDE VIEW

PLAN VIEW

## RANGE OF APPLICATION

Business premises, hotel, residential property, discothèque, theatre...

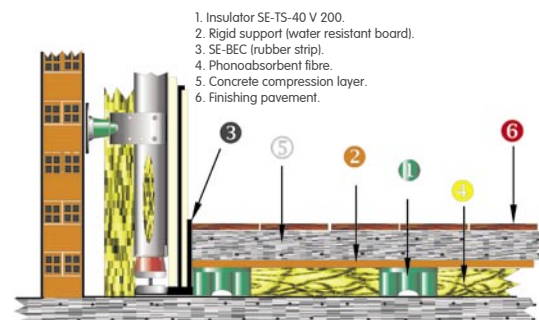

1. Insulator SE-TS-40 V 200.
2. Rigid support (water resistant board).
3. SE-BEC (rubber strip).
4. Phonoabsorbent fibre.
5. Concrete compression layer.
6. Finishing pavement.

## OPTIMUM LOAD RANGE

### SE-TS-40 V 200



(80-200) Kg

LOAD (Kg)	RESONANCE FREQUENCY (Hz)	RESONANCE AMPLIFICATION	ISOLAITON THRESHOLD (Hz)
100	10,30	6,80	16,90
200	12,00	8,25	18,50
250	11,50	7,10	17,50
300	12,30	7,60	18,30

### SE-TS-80 A 400



(200-400) Kg

LOAD (Kg)	RESONANCE FREQUENCY (Hz)	RESONANCE AMPLIFICATION	ISOLAITON THRESHOLD (Hz)
300	11,50	7,10	17,50
400	9,33	5,89	16,20
450	10,25	6,33	16,90
500	13,89	7,34	17,90

## DEFLECTION TEST

**Description/Make:**  
RIEHLE Testing machine

**Code:**  
ME 035006

**Traceability/Date of calibration:**  
13 Mayo 1999

**Results obtained:**  
Sample isolator MOD. TS-40 V 200. Designed for loads ranging from 80 to 200 Kg. **Results obtained are above standard.**

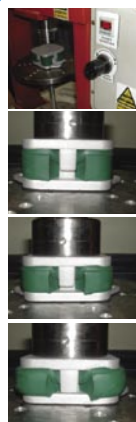

1. Test overview.
2. With a load of 0 Kg. The elastic EPDM body has a height of 30 mm.
3. With a 100 Kg. the height of the EPDM body suffers a 3,5 mm loss.
4. At 300 Kg. we have a 7,2 mm height loss.

## DEFLECTION TEST

**Description/Make:**  
RIEHLE Testing machine

**Code:**  
ME 035005

**Traceability/Date of calibration:**  
13 Mayo 1999

**Results obtained:**  
Sample isolator MOD. TS-80-A 400. Designed for loads ranging from 200 to 400 Kg. **Results obtained are above standard.**

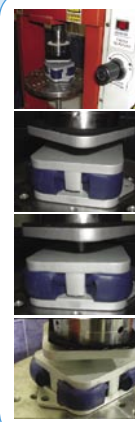

1. Test overview. 0 Kg load, EPDM body of 30 mm. height
2. With a 200 Kg. load we have a 4 mm height loss.
3. With a 300 Kg load we have a 8 mm height loss.
4. At 400 Kg. 10 mm. Height loss.